

**Panel mounted inlet - Part no. 3658**

- screw terminals
- with highly heat resistant contact carrier
- nickel plated contacts
- 63A: a retaining nose to hold the hinged lid of the connector must be provided by the customer in order to ensure satisfactory locking

Protection type IP 67  
 Ampere 63A  
 Poles 5p  
 Voltage 400V  
 Hertz 50-60Hz  
 Earth position 6h  
 Contact nickel plated contacts, highly heat resistant contact carrier  
 Connection technology Screw terminals



Std. Pack. 5 Qty.

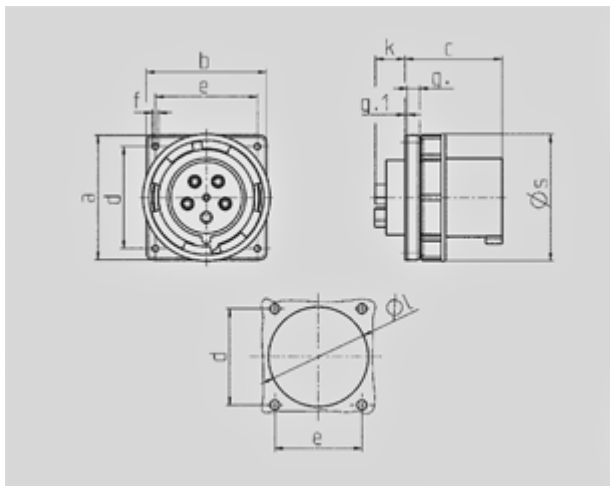

Drawing	Amp.	63			125		
		3	4	5	3	4	5
2 MB 166	Poles						
Dim. in mm	a	110	110	110	130	130	130
	b	106	106	106	130	130	130
	c	86	86	86	112	112	112
	d	90	90	90	104	104	104
	e	90	90	90	104	104	104
	f	5,5	5,5	5,5	6,5	6,5	6,5
	g.	12	12	12	18	18	18
	g.1	2	2	2	2	2	2
	k	28	28	28	28	28	28
	l	88.5	88.5	88.5	95	95	95
	s	113	113	113	132	132	132
	Terminal for cond. cross section (mm <sup>2</sup> ) min.-max.	6	6	6	25	25	25
		-16	-16	-16	-70	-70	-70